

Angle Aide

Mfg. by
Enfield Machine Tool Co.
RFD #1
Enfield, New Hampshire
1-603-632-4866

Angle Aide is a new device that allows accurate and fast setup in a Bridgeport #2 vise of any angle desired.

Setup person does not have to have an in-depth knowledge of trigonometry. (Ready Reference Chart included.)

Extreme accuracy. (Single part or short run production.)

Universal use (milling, grinding, inspection).

It's Also Reversible

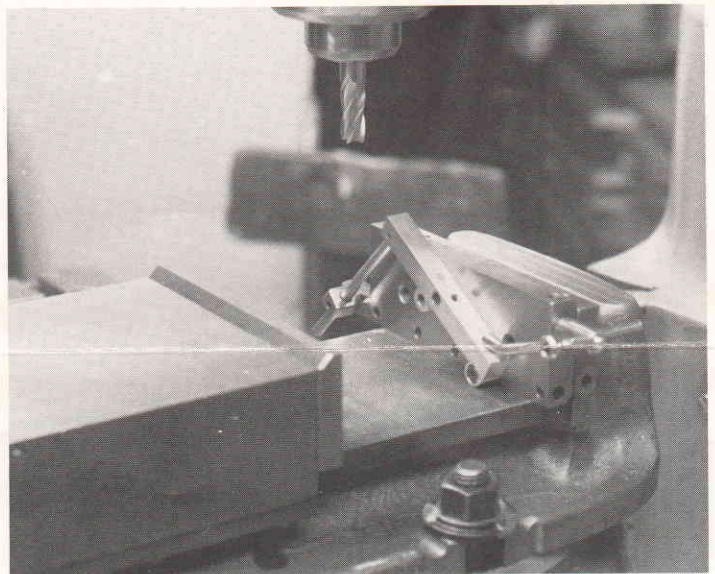
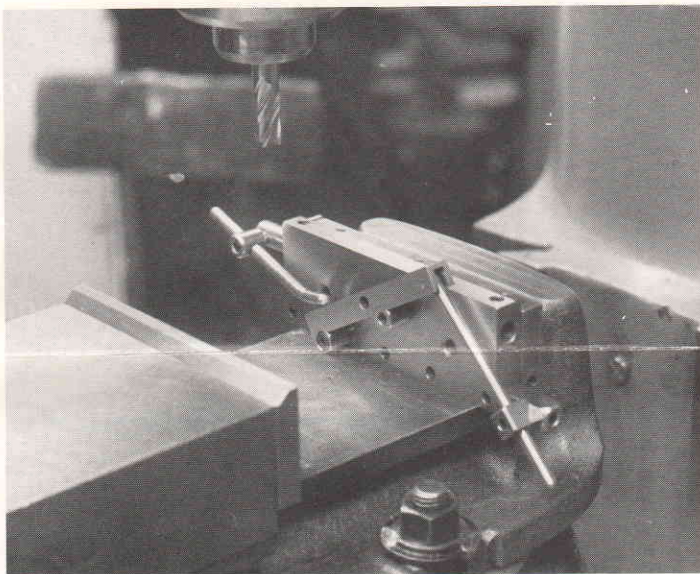

All components are heat-treated steel except for black oxidized accessories. They are soft C.R.S. so that operator can hit them without hurting cutting tool.

Accuracy guarantee of ± 2 minutes included.

See reverse for setup instructions.

1. Preassemble sine bar on vise jaw and mount in vise.
2. Tighten vise jaw by 3/8 cap screws and tap down with lead.
3. Place block gauges under location roller and with finger pressure tighten 3 set screws (1, 2, 3) as shown in picture. This sequence must be followed for accuracy.
4. Test block gauges for "friction" under roller. If friction is felt, you have an accurate setup.
5. Remove block gauges.

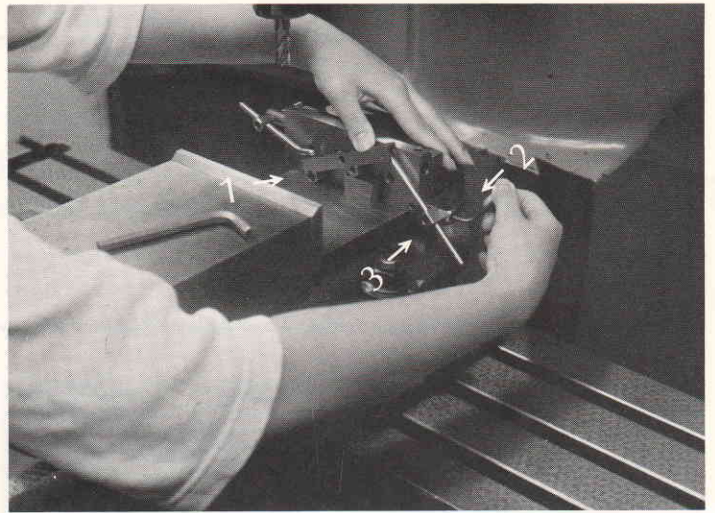

To:

From:

For Demonstration Call Your Area Distributor.

DISTRIBUTED BY
ACE INDUSTRIAL HARDWARE
Cutting Tools - Fasteners - Abrasives
5 Starr St. Danbury, Conn. 06810
Phone (203) 743-7686